

■ Features

- Single output to 1200W
- Input voltage range: 90-264V
- Configurable outputs
- Primary side remote on/off function
- 6"x6" Form Factor
- Efficiency to 89%
- Remote current /voltage programming
- Parallel & series connection of modules
- Accurate current sharing
- User and field configurable
- 3-year Warranty



\*Product images are for illustrative purposes only and may vary from actual design.

■ Applications

- Medical grade equipment

■ Technical Data

AC Input Voltage	90-264Vac
AC Input Frequency	47-63Hz; 50/60Hz typical
DC Input Voltage	120-370Vdc
Output Power Rating	1200Watts
Input Current	1200W output at 120Vac input; 12A
Input Current Limit	14A
Inrush Current	265Vac, 25°C(cold start); 40A
Fusing	Each line fused (5x20 Fast acting); 12.5A
Efficiency	86%-89%
No Load Power Consumption	All output fitted and disabled/enabled; 32/46W
Standby power	2.5W
Power Factor	0.99, 0.99
Hold up	1200W output@120Vac input Min.: 17mS, Typ.:20mS, Max.: 21mS
UVLO	Turn on under voltage protection 78-84Vac
Over Temperature	Internally monitored 115-125°C
Reliability	40° 80% load 2 FPMH
Size	152.4x152.4x40.9mm
Weight	360+60(per output module)
Mounting	Bottom or side mounting(see diagram for details)

[2D model](#)

[Remote Voltage and Current Control](#)

■ Installation

Parameter	Details	Parameter	Details
Equipment Class	I	Flammability rating	94V-2
Installation category	II	IP rating	IP10
Pollution degree	2	ROHS Compliance	2002/95/EC
Material group	IIIb		Indoor use only

**Technical Sales / Customer Service:** +1-818-338-7788 • Email: [sales@autec.com](mailto:sales@autec.com)  
 31328 Via Colinas Suite 102 • Westlake Village, CA 91362 USA • [www.autec.com](http://www.autec.com)

■ Global Signals Specifications

Bias Voltage	Min.: 4.8V, Typ.: 5V, Max.:5.2V
Bias Current	Hiccup type current limit 1A
Power Good Voltage	PNP open collector with internal 10k pull down resistor; Min: 8, Typ: 10, Max: 15V
Power Good Current	0-20mA
Inhibit Voltage	Min: 2V, Max: 15V
Inhibit Current	10k ohm input impedance Min: 0.2mA Max:1.5mA
Global inhibit voltage	Min: 3V, Max: 15V
Global inhibit current	5k ohm input impedance Min: 0.6mA Max: 3mA
AC_OK Voltage	High output: Min: 4.7V, Max: 5.2V Low output: 0.1V
AC_OK Current	Min: -10mA, Max: 10mA
AC_OK warning	See user manual for exceptions 5mS
Primary Bias Voltage	Medically Isolated 5mS
Primary Bias Current	Hiccup type current limit; 0.5A
Primary Remote on/off	Negative Edge triggered, refer to User Manual 5V

■ Safety and EMC

IEC/EN60601-1	3 <sup>rd</sup> edition
UL60601-1	3 <sup>rd</sup> edition
CAN/CSA-C22.2 No. 60601-1(2008)	
ANSI/AAMI ES60601-1 (2005+C1:09+A2:10)	
CE Mark	LVD 2014/35/EU

■ Connectors

Circuit	Details	
<b>J1</b>		
1	Live	
2	Earth	
3	Neutral	
<b>J2a/b</b>		
1	Power Good	Slot A and E
2	Inhibit	
3	Power Good	Slot B and F
4	Inhibit	
5	Power Good	Slot C and G
6	Inhibit	
7	Power Good	Slot D and H
8	Inhibit	
9	Global Inhibit	
10	AC OK	
11	+5V 1A bias supply	
12	COM	
<b>J6</b>		
1	Common	
2	+5V 500mA Bias	
3	Shut down	
4	Reserved	
5	Reserved	
6	Reserved	

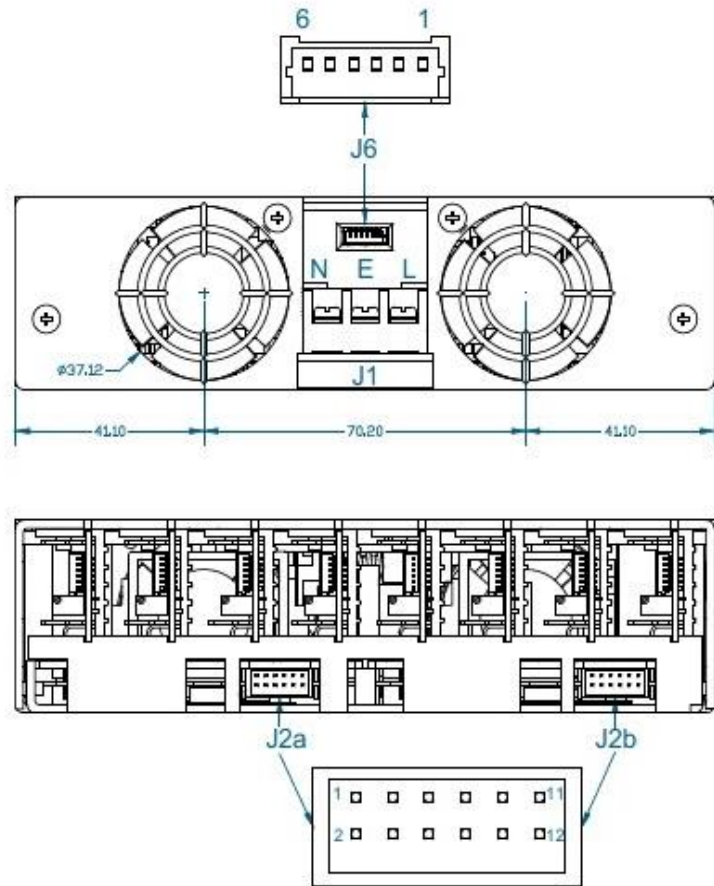

Mating Connectors				
Ref.	Details	Man.	Housing	Terminal
J1	Mains input: 3 Pin, Barrier, 6-32 Steel Screws, 0.8NM or 7IN LB torque cable 14-18AWG, 300V, 16A, 105°C, use appropriately rated fork or ring terminal	Molex		
J2a/b	Global Signals: 12Pin, 2mm, without friction lock, 24-30 AWG	Molex	511101251	503948051
J6	Input Bias: Output signals: 6 Pin, 1.25mm, with friction lock, 28-32AWG	Molex	510210600	500588000
Notes:				
1. Direct equivalents may be used for any connector parts.				
2. All cables must be rated 105°C min, equivalent to UL1015				

■ **Mechanical Diagram**

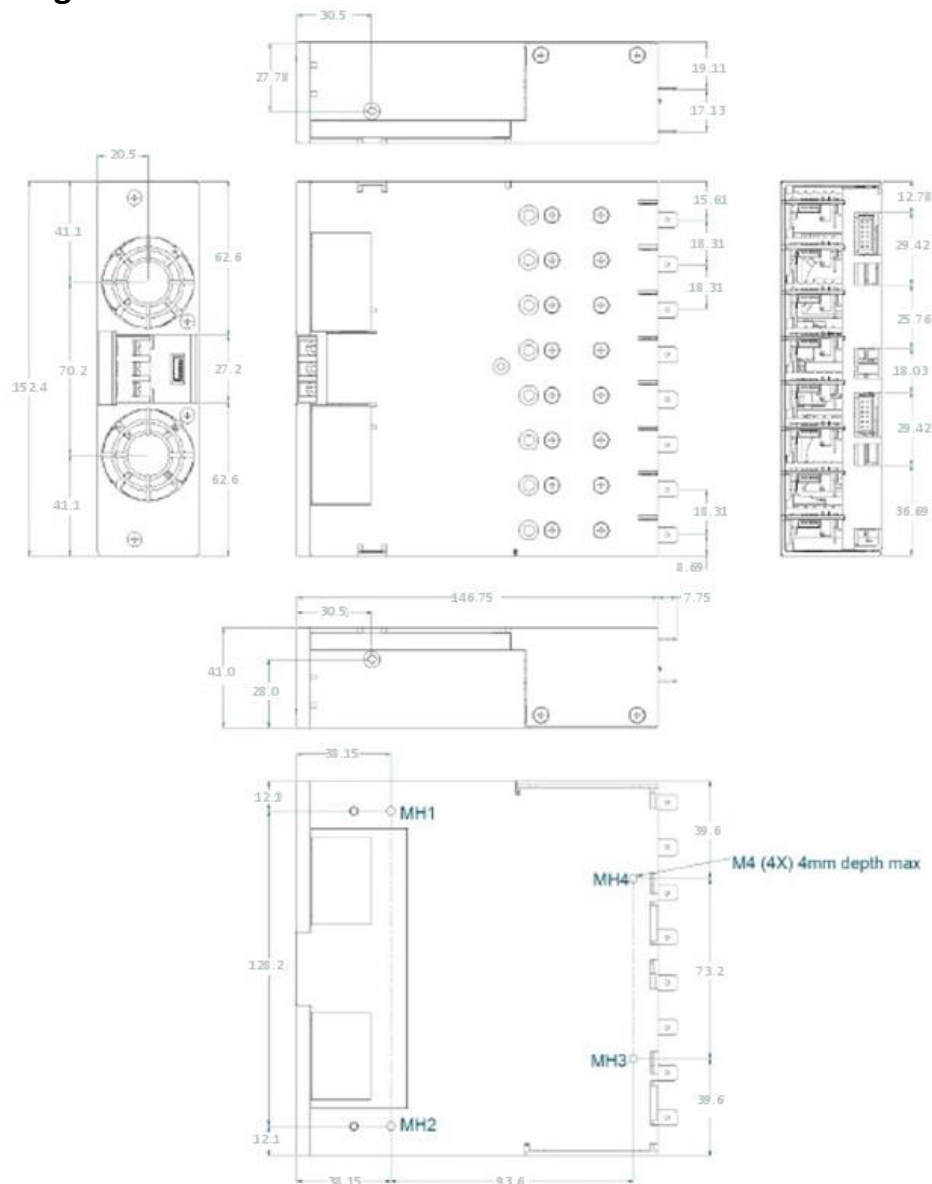

<b>Screws</b>			
Location	Details	Penetration	Tightening
Mounting	M4 x 4	4mm max including chassis	0.55NM(1)
Output modules	M3 x 5, Countersink Posi, 16 places	Defined by screw	0.35NM(1)
Chassis lid and faceplate	M3 x 5, Countersink Posi, 11 places	Defined by screw	0.35NM(1)
1. Torque settings are for general reference only. The Torque settings shown in the datasheet are the insert manufacturers recommended values			

■ Efficiency vs Load

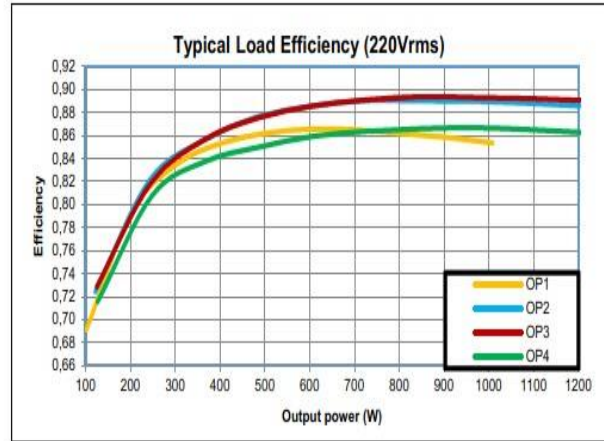
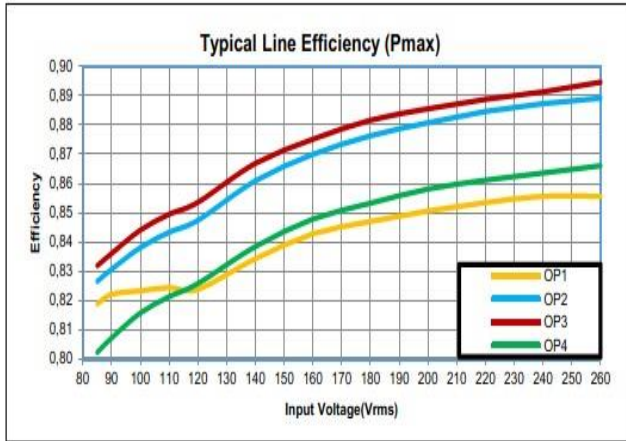

■ Derating Curve

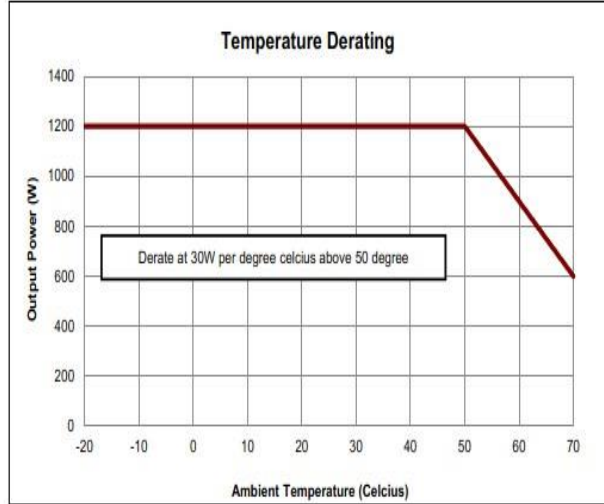
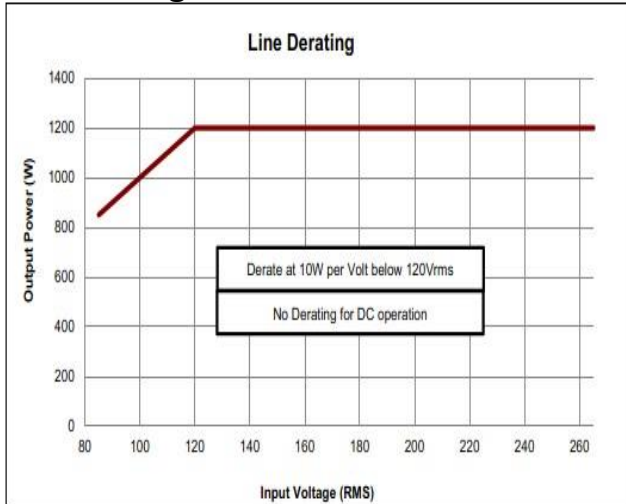

■ Typical Conducted Emissions

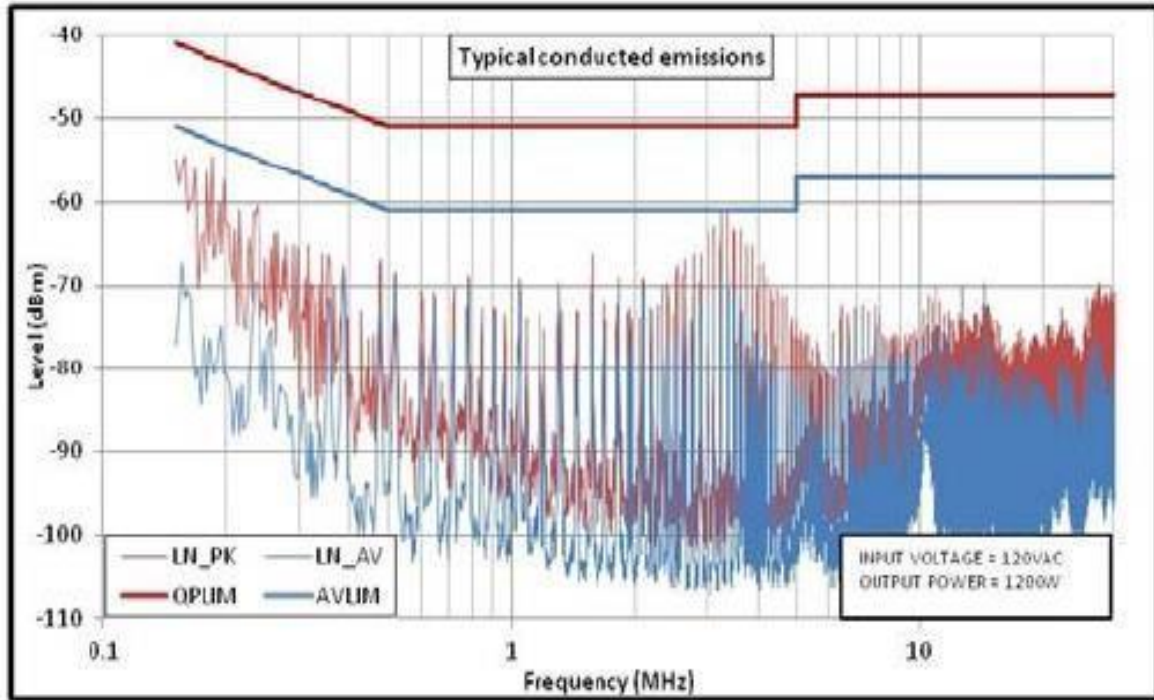

**Part Number Scheme**

**HP NEO-M 1200**

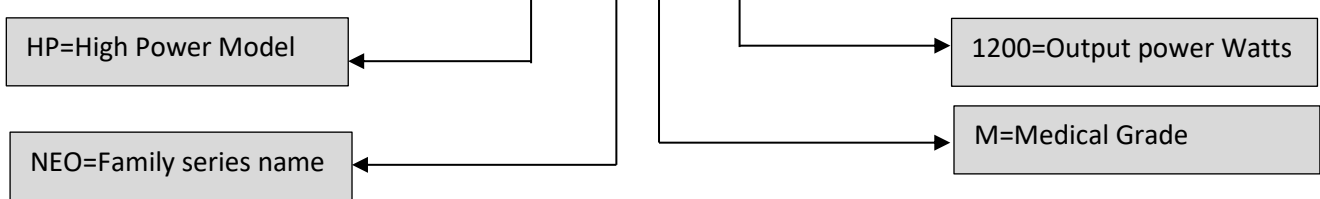

\*Product images are for illustrative purposes only and may vary from actual design.

\*Specifications are subject to change without notice. Autec is not responsible for issues arising from errors or omissions.

Technical Sales / Customer Service: +1-818-338-7788 • Email: [sales@autec.com](mailto:sales@autec.com)  
31328 Via Colinas Suite 102 • Westlake Village, CA 91362 USA • [www.autec.com](http://www.autec.com)